



Welcome to the Year 9 Options Evening

Subject Choices for Moving Into Key Stage 4 – Years 10 & 11



Ashlyns School
2020 – 2022
Curriculum Options for
Years 10 and 11



Issue Date: January 2020

PLEASE RETAIN THIS BOOKLET FOR FUTURE REFERENCE
or see our website www.ashlyns.herts.sch.uk





Purpose of this evening

- Information about the curriculum offer
- Detailed subject information
- The process after tonight



Sources of Information

- Options booklet & subject presentations
- Careers advice
- Subject staff
- Head of Year, Form Tutor & Inclusion Staff
- Individual interviews if appropriate
- Other students
- Parents and family



Good reasons to choose a subject

You should choose a subject that...

- You can do well in
- You like
- Reflects your interests and personal qualities
- Helps you learn in the best way for you
- Helps keep your options open for the future



Bad reasons to choose a subject

Don't choose subjects just because...

- Your best friend is doing it
- You like the teacher



Compulsory Core Curriculum

- English Language 1 GCSE
- English Literature 1 GCSE
- Mathematics 1 GCSE
- Combined Science 2 GCSEs
- RE (Philosophy and Ethics) 1 GCSE
- Physical Education
- PSHE



The E-Bacc

English Language and Literature

Mathematics

Two Sciences

Modern Foreign Language

History or Geography.



Please select 4 Options in order of preference 1 - 4, plus 1 reserve (R), from columns 2 and 3

Column 1 Core Curriculum All students study:
English Language & English Literature (2 GCSEs)
Maths
Science (2 GCSEs)
Religious Studies (Philosophy & Ethics)
PE – Core (non-GCSE)

Column 2 Facilitating Subjects Choose <u>at least</u> one subject from this column (you may choose more, and most students choose two):
Triple Science (Set 1 scientists and many Set 2 students should select this)
French
Spanish
Geography
History

Column 3 Open Choice:
Art & Design
Business Studies (GCSE or Cambridge Nationals)*
Computer Science
Citizenship
Drama
Exam PE (GCSE or Cambridge Nationals)*
Film Studies
Food Preparation & Nutrition
Music
Product Design - Materials Specification
Product Design - Textiles Specification
EPQ Level 2
Health & Social Care BTEC

Student Name: _____

Form: _____

Parent/Carer Name: _____

Parent/Carer signature: _____

Please hand to Form Tutor by Friday 6 March 2020

*** Students will be allocated either GCSE or the Level 2 Cambridge Nationals**





A balanced programme: Column 2

‘Facilitating subjects’:

select at least 1 from:

- Triple Science
- French
- Spanish
- Geography
- History

Column 2 ‘Facilitating Subjects’ Choose <u>at least</u> one subject from this column (you may choose more):	
Triple Science (Set 1 scientists and many Set 2 students should select this)	
French	
Spanish	
Geography	
History	



Science

- Most students study Combined Science (Trilogy) worth 2 GCSEs
- Triple Science (Biology, Chemistry, Physics): set 1 scientists and many set 2 scientists
- This takes up one of the 4 options and so would replace the 4th choice subject
- At least two 6s in Combined or Triple Science enables studying A levels in Science and a degree in a Science discipline



A balanced programme: Column 3

1. 'Practical' subjects
2. 'New' subjects
3. Exam PE vs 'Core' PE
4. Extended Project Qualification
5. Health and Social Care BTEC
6. Cambridge Nationals/GCSEs

Column 3 Open Choice:	
Art & Design	
Business Studies(GCSE or Cambridge Nationals)*	
Computer Science	
Citizenship	
Drama	
Exam PE (GCSE or Cambridge Nationals)*	
Film Studies	
Food Preparation & Nutrition	
Music	
Product Design (Materials Specification)	
Product Design (Textiles Specification)	
EPQ Level 2	
Health & Social Care BTEC	

Column 2
'Facilitating Subjects'
 Choose at least one subject from this column (you may choose more):

Triple Science (Set 1 scientists and many Set 2 students should select this)	
French	
Spanish	
Geography	
History	

Column 3
Open Choice:

Art & Design	
Business Studies (GCSE or Cambridge Nationals)*	
Computer Science	
Citizenship	
Drama	
Exam PE (GCSE or Cambridge Nationals)*	
Film Studies	
Food Preparation & Nutrition	
Music	
Product Design (Materials Specification)	
Product Design (Textiles Specification)	
EPQ Level 2	
Health & Social Care BTEC	



Column 2
'Facilitating Subjects'
 Choose at least one subject from this column (you may choose more):

Triple Science (Set 1 scientists and many Set 2 students should select this)	
French	
Spanish	
Geography	
History	

Column 3
Open Choice:

Art & Design	
Business Studies (GCSE or Cambridge Nationals)*	
Computer Science	
Citizenship	
Drama	
Exam PE (GCSE or Cambridge Nationals)*	
Film Studies	
Food Preparation & Nutrition	
Music	
Product Design (Materials Specification)	
Product Design (Textiles Specification)	
EPQ Level 2	
Health & Social Care BTEC	



Programme of Presentations



Tonight!

- 5 x 15-minute slots: a single bell signals the start of a talk; a double bell signals the end!
- 7:20
- 7:40
- 8:00
- 8:20
- 8:40

Room	7:20	7:40	8:00	8:20	8:40
Chapel	History	History		History	
F56	Design and Technology (Materials Specialism)	Design and Technology (Materials Specialism)	Art	Art	Art
F42	Design and Technology (Textiles Specialism)	Design and Technology (Textiles Specialism)			
84	Health and Social Care BTEC	Health and Social Care BTEC	PE	PE	PE
86	Triple Science	Triple Science	Triple Science	EPQ Level 1/2	EPQ Level 1/2
88	Computer Science	Computer Science	Computer Science	Film Studies	Film Studies
107	Food Preparation & Nutrition	Food Preparation & Nutrition	Music	Music	Music
110	French	French	Spanish	Spanish	Spanish
Drama Studio	Drama		Drama	Drama	Food Preparation & Nutrition
113	Geography	Film Studies	Geography	Geography	French
Hall	Citizenship	Citizenship	Business Studies	Business Studies	Business Studies
6 th Form Dining Room	Individual Advice & Refreshments	Individual Advice & Refreshments	Individual Advice & Refreshments		

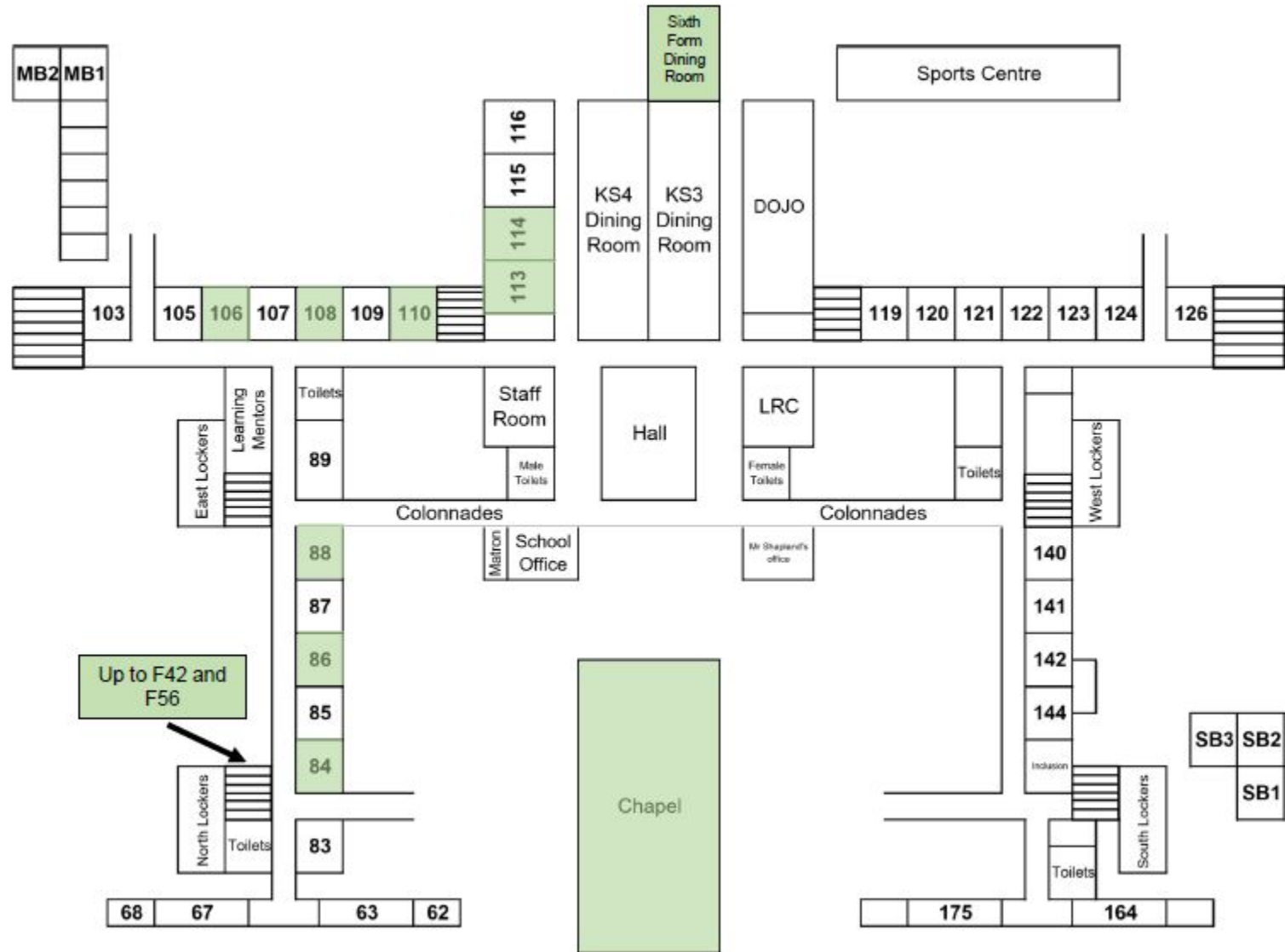



After Tonight

- Questions?